

NON-INSULATED SHACKLES

Part Numbers Listed Next to the Product Photographs



Excellence in Aerospace since 1943

P/N 16645
P/N 13903



P/N 15154
(termination Unit with
P/N 15167 Tension Unit)



P/N 12348-D



P/N 20ARM300-21C-3
(P/N 15AARM300-21
Grounding Strap)



P/N 20ARM300-21C



NON-INSULATED SHACKLES

These non-insulated shackles are fitted with chuck jaws to accept antenna wire PN 14379. There is direct continuity between the chuck jaws and the termination fitting. They are all rated at 400 lbs. maximum load except for PN 15154, which is rated at 800 lbs.

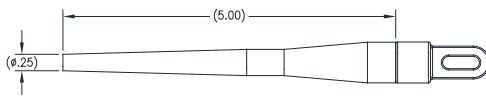

P/N 15154

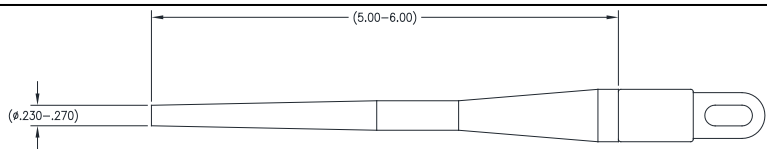

P/N TU10-742

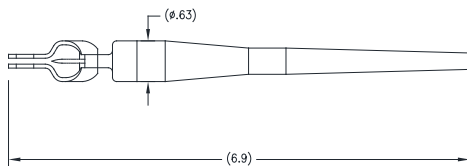

P/N 13903

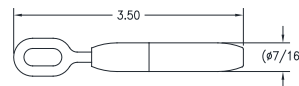

P/N 20ARM300-21C

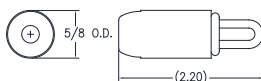

P/N 12348

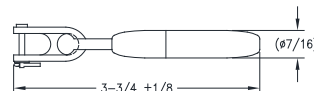

P/N 20ARM300-21C-3